

MAX MAP 54-7, PARCEL A-1100
 ROLL 276 / MADE 837

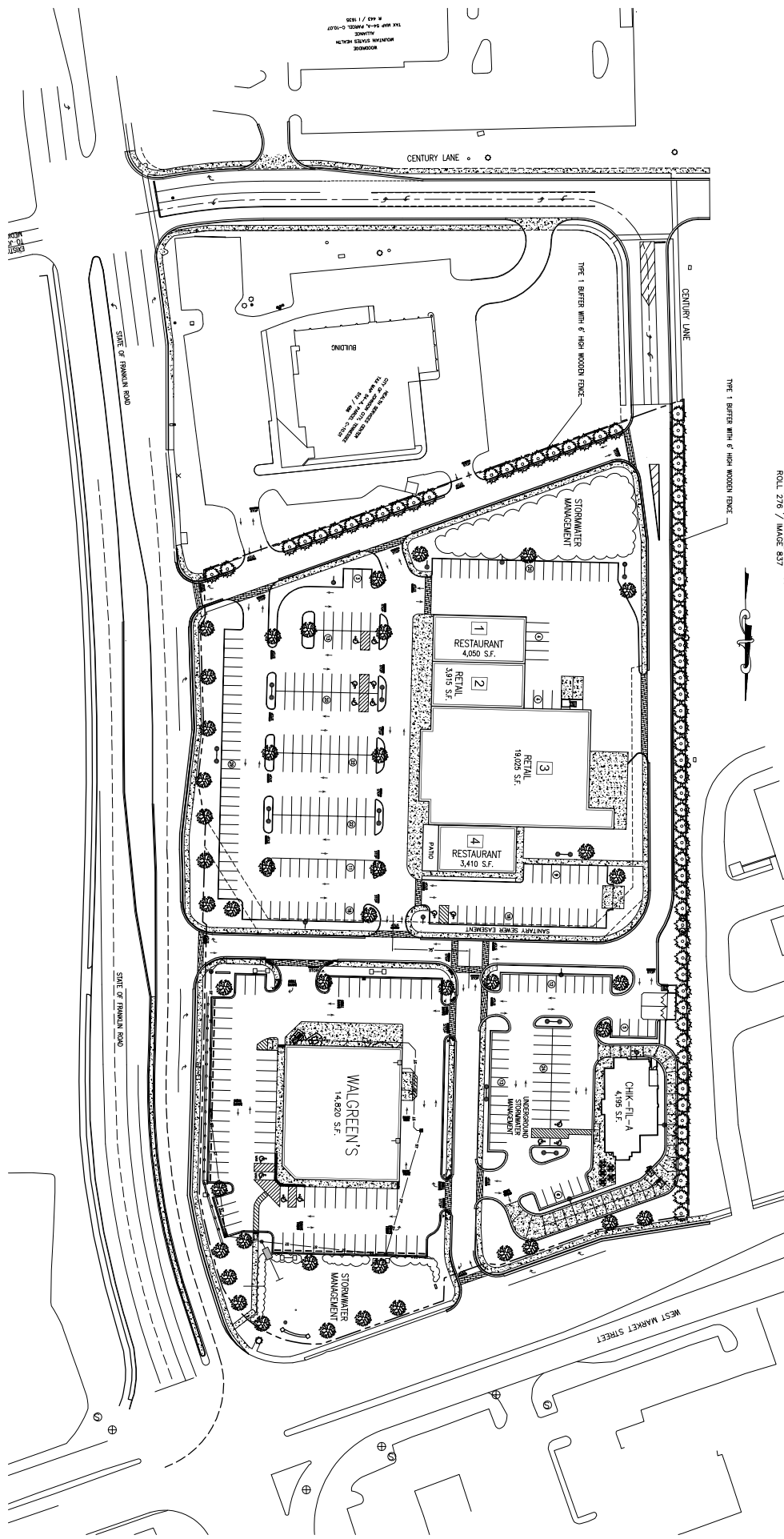

PARKING TABULATION
 (NOT INCLUDING WALGREENS OR CHIK-FIL-A)
 TOTAL RETAIL AREA = 22,940 S.F.
 PARKING SPACES REQUIRED FOR RETAIL AREA = 1115 SPACES
 TOTAL RESTAURANT AREA = 7,460 S.F.
 PARKING SPACES REQUIRED FOR RESTAURANTS = 75 SPACES
 TOTAL PARKING SPACES REQUIRED = 1190 SPACES
 TOTAL PARKING SPACES PROVIDED = 193 SPACES

**CONCEPT PLAN FOR
 INNOVATION PARK PLAZA
 JOHNSON CITY, TENNESSEE**

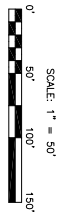

BUILDING HEIGHT NOTE
 NONE OF THE BUILDINGS SHALL EXCEED THE MAXIMUM BUILDING HEIGHT ALLOWED BY THE CITY UNDER THE PB ZONING REGULATIONS.

OUTDOOR LIGHTING NOTE
 ALL LIGHT FIXTURES SHALL BE PROVIDED TO THE CITY FOR THEIR REVIEW AND APPROVAL FOR THE PROPOSED LIGHTING LAYOUT BEFORE THE FINAL LIGHTING PLAN SHALL BE SUBMITTED TO THE CITY.

BARRIER NOTE
 ALL BARRIERS SHALL BE PROVIDED WITH 6' HIGH FENCE AND DEEPENED TREES TO BE CONSTRUCTED IN ACCORDANCE WITH THE CITY REGULATIONS ALONG THE WESTERN AND SOUTHERN PROPERTY LINES.

LEGEND

	EXISTING LIGHT
	EXISTING STREET DECKLIGHT
	EXISTING SIGNAL LINE
	PROPOSED LIGHT